

CAPA FINA PLUS

VISANREVES



Characteristics

VISANREVES CAPA FINA PLUS is a high-quality, high-whiteness mineral mortar designed for the rendering and decoration of façades, featuring waterproof and breathable properties.

This cement-based product contains mineral pigments, selected aggregates, and specific additives to ensure excellent workability and a superior decorative finish. It is suitable for both manual and machine application, providing good performance in both interior and exterior environments.

A product that decorates, protects, and delivers outstanding whiteness with a natural finish, contributing to a healthier environment—all in a single application.

Applications

Suitable for application as a second coat or intermediate layer to achieve a fine, smooth, or sponge finish.

The thickness shall be between 3 and 10 mm. It can be applied both indoors and outdoors, on walls and ceilings, in new construction as well as renovation projects.

If it is to be applied over concrete or precast panels, the use of a bonding bridge is required.

Waterproofing performance will be more effective provided that, after smoothing or sponge finishing, the final layer thickness is not less than 5 mm.

Storage

The product should be kept in its original packaging and stored in a dry place, this way, it can be stored for up to twelve months.

PHYSICAL AND CHEMICAL PROPERTIES

Product type	CR CS IV W2
Appearance	White powder
Bulk density	1,5 ± 0,1 gr/cm ³
Mixing water	23 ± 2 % (5,25 - 6,25 L per bag)
Coverage*	16 kg/m ²
Open time**	30 minutes.
Maximum thickness per coat	10 mm
Curing time**	1 - 4 hours
Flexural strength test	≥ 1 N/mm ²
Compressive strength test	R _c ≥ 6
Adhesion to ceramic brick	≥ 0.3 N/mm ²
Water absorption coefficient by capillarity (kg/m ² min ^{0.5})	W _{c2} ≤ 0,2
Reaction to fire	CLASS A1

* Test carried out at 10 mm thickness.

** Tests performed under normal ambient conditions 20 °C and 60% relative humidity. Variations in these conditions will result in variations in the stated times.



Instructions for use

Mix with the indicated amount of water.

Apply manually or by machine.

Spread evenly, leaving the most uniform layer possible.

The substrate must be clean and free of laitance and release agents.

Do not apply on damp surfaces or on substrates with loose particles.

Do not apply on gypsum-based substrates or on painted surfaces.

Compliance Standards

Do not apply on substrates affected by moisture.

Application temperature: from + 5°C to + 30°C.

Do not apply in direct sunlight, strong wind, rain, or where there is a risk of frost.

Apply on substrates such as brick or block, previously rendered or leveled.

The product layer thickness shall be between 3 and 10 mm.

For each mix, strictly follow the indicated water ratio to avoid color variations.

Presentation

It is packaged in double-layer paper bags with a plastic sheet. The product is presented on shrink-wrapped pallets with 56 bags (1400 kg) of 25 kg each.



CAPA GRUESA PLUS

VISANREVES



Characteristics

VISANREVES CAPA GRUESA PLUS is a high-quality, high-whiteness mineral mortar for façade coating and decoration, featuring waterproof and breathable properties.

This cement-based product contains mineral pigments, selected aggregates, and specific additives to ensure excellent workability and a superior decorative finish. It is suitable for both manual and machine application, providing strong performance in both interior and exterior environments.

The product decorates, protects, and delivers outstanding whiteness with a natural finish, creating a healthier living environment all in a single application.

Applications

The product provides a fine-textured finish, allowing for smoothing, sponge finishing, floating, or scraping.

The recommended thickness is 10 to 15 mm. It can be applied both indoors and outdoors, on walls and ceiling, in new construction as well as renovation projects.

If it is to be applied over concrete or precast panels, the use of a bonding bridge is required.

Waterproofing performance will be more effective provided that, after achieving the desired finish, the final thickness is not less than 7-8 mm.

Storage

The product should be kept in its original packaging and stored in a dry place, this way, it can be stored for up to twelve months.

PHYSICAL AND CHEMICAL PROPERTIES

Product type	CR CS IV W2
Appearance	White powder
Bulk density	1,5 ± 0,1 gr/cm ³
Mixing water	23 ± 2 % (5,25 - 6,25 L per bag)
Coverage*	16 kg/m ²
Open time**	30 minutes.
Maximum thickness per coat	15 mm
Curing time**	1 - 4 hours
Flexural strength test	≥ 1 N/mm ²
Compressive strength test	R _c ≥ 6 N/mm ²
Adhesion to ceramic brick	≥ 0,3 N/mm ²
Water absorption coefficient by capillarity (kg/m ² min ^{0.5})	W _{a2} ≤ 0,2
Reaction to fire	CLASS A1

* Test carried out at 10 mm thickness.

** Tests performed under normal ambient conditions 20 °C and 60% relative humidity. Variations in these conditions will result in variations in the stated times.

Instructions for use

Mix with the indicated amount of water.

Apply manually or by machine.

Spread evenly, leaving the most uniform layer possible.

The substrate must be clean and free of laitance and release agents.

Do not apply on damp surfaces or on substrates with loose particles.

Do not apply on gypsum-based substrates or on painted surfaces.

Compliance Standards

Do not apply on substrates affected by moisture.

Application temperature: from + 5 °C to + 30 °C.

Do not apply in direct sunlight, strong wind, rain, or when there is a risk of frost.

Do not apply in direct sunlight, strong wind, rain, or when there is a risk of frost.

Apply on substrates such as brick or block, previously rendered or leveled.

The product layer thickness shall be between 10 and 15 mm.

For each mix respect the indicated water ratio to avoid color variations.

Presentation

It is packaged in double-layer paper bags with a plastic sheet. The product is presented on shrink-wrapped pallets with 56 bags (1400 kg) of 25 kg each.



MONOCAPA PIEDRA

VISANREVES



Characteristics

VISANREVES MONOCAPA PIEDRA is a white mineral-based mortar for façade coating and decoration. It is waterproof, breathable, and optionally available in color, designed to achieve a projected stone finish.

This cement-based product incorporates mineral pigments, selected lightweight aggregates, and specific additives to ensure good workability and an decorative finish. It is suitable for manual application, providing strong exterior durability and proper breathability to prevent internal condensation.

A product that decorates and protects, allowing the wall to breathe and contributing to a healthier home environment.

Available in all colors from our color chart.

Applications

It is a projected stone finish product suitable for the coating and decoration of façades. The minimum application thickness shall be 10 mm. It can be applied both indoors and outdoors, on walls and ceilings, in new construction as well as renovation projects.

If it is to be applied over concrete or precast panels, the use of a bonding bridge is required.

Waterproofing performance will be more effective when the applied layer is not less than 10 mm thick.

Storage

The product should be kept in its original packaging and stored in a dry place, this way, it can be stored for up to twelve months.

PHYSICAL AND CHEMICAL PROPERTIES

Product type	OC CS II W2
Appearance	White or colored powder
Bulk density	1,1 ± 0,1 gr/cm ³
Mixing water	38 ± 2 % (9-10 L per bag)
Hardened product density	1,2 ± 0,1 gr/cm ³
Coverage*	13 kg/m ²
Open time**	30 - 45 minutes
Maximum thickness per coat	10 mm
Flexural strength test	≥ 1 N/mm ²
Compressive strength test	1,5 ≤ R _c ≤ 5
Adhesion to ceramic brick	≥ 0,3 N/mm ²
Water absorption coefficient by capillarity (kg/m ² min ^{0.5})	W _{a2} ≤ 0.4
Reaction to fire	CLASS A1

* Test carried out at 10 mm thickness.

** Tests performed under normal ambient conditions 20 °C and 60% relative humidity. Variations in these conditions will result in variations in the stated times.



Instructions for use

Mix with the indicated amount of water and allow to rest for 5 minutes. Apply manually.

Spread evenly, ensuring a minimum thickness of 10 mm per coat.

After 10 to 45 minutes, depending on ambient application conditions, project the aggregate.

After a few minutes, press with a trowel to embed the stone into the mortar.

The substrate must be clean and free of laitance and release agents.

Do not apply on damp surfaces, on substrates with loose particles, or on gypsum-based or painted substrates.

Compliance Standards

Do not apply on substrates affected by moisture.

Application temperature: from + 5 °C to + 30 °C.

Do not apply in direct sunlight, strong wind, rain, or when is a risk of frost.

Do not apply on damp surfaces or on substrates with loose particles.

Do not apply on gypsum-based substrates or on painted surfaces.

The minimum product layer thickness shall be 10 mm.

For each mix, respect the indicated water ratio to avoid color variations.

Presentation

It is packaged in double-layer paper bags with a plastic sheet. The product is presented on shrink-wrapped pallets with 56 bags (1400 kg) of 25 kg each.



MONOCAPA

RASPADO ZERO

VISANREVES



Characteristics

VISANREVES RASPADO ZERO is a white mineral-based mortar for façade coating and decoration. It is waterproof, breathable, and optionally available in color. It is designed to achieve a scraped finish.

This cement-based product contains inorganic pigments, selected aggregates, and specific additives to ensure good workability and a high-quality decorative finish. It can be applied either manually or by machine, providing excellent durability for exterior applications.

A product that decorates and protects, allowing the wall to breathe and contributing to a healthier home environment.

Available in all colors from our color chart.

Applications

It is a scraped finish product, suitable for cladding and decorating brick and concrete block facades. The minimum thickness is 12-15 mm, applicable both indoors and outdoors, on walls and ceilings, in new construction and renovation projects.

Since it can be applied directly to brick, a preliminary layer of plaster is not required.

If it is to be used on concrete or precast slabs, a bonding agent must be applied.

Waterproofing will be most effective when the applied layer after scraping is at least 10 mm thick.

The product provides a fine textured finish, allowing it to be washed or troweled.

Storage

The product should be kept in its original packaging and stored in a dry place, this way, it can be stored for up to twelve months.

PHYSICAL AND CHEMICAL PROPERTIES

Product type	OCCS III W2
Appearance	White or colored powder
Bulk density	1,6 ± 0,1 g/cm ³
Mixing water	23 ± 2 % (5,25 - 6,25 L per bag)
Hardened product density	1,7 ± 0,1 g/cm ³
Coverage*	18 kg/m ²
Open time**	20 min
Maximum thickness per coat	15 mm
Re-scraping time**	4 - 6 hours
Flexural strength test	≥ 1 N/mm ²
Compressive strength test	3,5 ≤ R _c ≤ 6,5 N/mm ²
Adhesion to ceramic brick	≥ 0,3 N/mm ²
Water absorption coefficient by capillarity (kg/m ² min ^{0.5})	W _{c2} ≤ 0,3
Reaction to fire	CLASS A1

* Test carried out at 10 mm thickness.

** Tests performed under normal ambient conditions 20 °C and 60% relative humidity. Variations in these conditions will result in variations in the stated times.



Instructions for use

Mix with indicated amount of water.

Apply manually or by machine projection.

Spread evenly, leaving the most uniform layer possible.

The substrate must be clean and free of laitance and release agents.

Do not apply on damp surfaces or on substrates with loose particles.

Do not apply on gypsum-based substrates or on painted surfaces.

Compliance Standards

Do not apply to surfaces affected by moisture.

Application temperature + 5 °C to + 30 °C.

Do not apply in direct sunlight, strong winds, rain, or when there is a risk of frost.

Do not apply intense colors at low temperatures to prevent efflorescence.

Do not apply to damp surfaces or surfaces with loose particles.

Do not apply to plaster or painted surfaces.

Apply to surfaces such as brick, block, or previously plastered or leveled surfaces. The thickness of the scraped product layer will be between 10 and 12 mm.

Respect the indicated water ratio in each bath to avoid changes in color.

Presentation

It is packaged in double-layer paper bags with a plastic sheet.

The product is presented on shrink-wrapped pallets with 56 bags (1400 kg) of 25 kg each.



CAPA FINA

VISANREVES



Characteristics

VISANREVES CAPA FINA is a mineral mortar designed for the rendering of interior courtyards, light wells, and common areas. This cement-based product contains selected aggregates and is properly modified with additives to ensure good workability. It is suitable for both manual and machine application, providing adequate performance for interior use. It offers a fast and practical solution for everyday construction work.

Applications

Suitable for application as a second coat or intermediate layer to achieve a fine, smooth, or sponge-finished surface. The recommended thickness is 3 to 10 mm. It can be applied both indoors and outdoors, on walls and ceilings, in new construction as well as renovation projects. If applied over concrete or precast panels, the use of a bonding bridge is required. Waterproofing performance will be more effective provided that, after smoothing or sponge finishing, the final thickness is not less than 5 mm.

Storage

The product should be kept in its original packaging and stored in a dry place, this way, it can be stored for up to twelve months.

Instructions for use

Mix with the indicated amount of water. Apply manually or by machine. Spread evenly, leaving the most uniform layer possible. The substrate must be clean and free of laitance and release agents. Do not apply on damp surfaces or on substrates with loose particles. Do not apply on gypsum-based substrates or on painted surfaces.

Compliance Standards

Do not apply on substrates affected by moisture. Application temperature: from +5°C to +30°C. Do not apply in direct sunlight, strong wind, rain, or where there is a risk of frost. Apply on substrates such as brick or block, previously rendered or leveled. The product layer thickness shall be between 3 and 10 mm. For each mix, strictly follow the indicated water ratio to avoid color variations.

Presentation

It is packaged in double-layer paper bags with a plastic sheet. The product is presented on shrink-wrapped pallets with 56 bags (1400 kg) of 25 kg each.

PHYSICAL AND CHEMICAL PROPERTIES

Product type	GP CS III W1
Appearance	White or gray powder
Bulk density	1,4 ± 0,1 gr/cm ³
Mixing water	23 ± 2 % (5,25 - 6,25 L per bag)
Coverage*	16 kg/m ²
Open time**	30 minutes.
Maximum thickness per coat	10 mm
Curing time**	1 - 4 hours
Flexural strength test	≥ 1 N/mm ²
Compressive strength test	3,5 ≤ R _c ≤ 6
Adhesion to ceramic brick	≥ 0,3 N/mm ²
Water absorption coefficient by capillarity (kg/m ² min ^{0,5})	W _{c2} ≤ 0,4
Reaction to fire	CLASS A1

* Test carried out at 10 mm thickness.

** Tests performed under normal ambient conditions 20°C and 60% relative humidity. Variations in these conditions will result in variations in the stated times.



CAPA GRUESA

VISANREVES



Characteristics

VISANREVES CAPA GRUESA is a mineral mortar for single-coat rendering or as an intermediate leveling layer to achieve the desired finish. It is suitable for interior courtyards, light well, and common areas.

This cement-based product contains selected aggregates and is suitably modified with additives to ensure good workability. It can be applied either manually or by machine, providing good performance in both interior and exterior applications.

It offers a fast, easy, and practical solution for everyday construction work.

Applications

The product provides a fine-textured finish, allowing for smoothing, sponge finishing, floating, or scraping.

The recommended thickness is 10 to 15 mm. It can be applied both indoors and outdoors, on walls and ceilings, in new construction as well as renovation projects.

If it is to be applied over concrete or precast panels, the use of a bonding bridge is required.

Waterproofing performance will be more effective provided that, after completing the desired finish, the final layer thickness is not

Storage

The product should be kept in its original packaging and stored in a dry place, this way, it can be stored for up to twelve months.

PHYSICAL AND CHEMICAL PROPERTIES

Product type	GP CS III W1
Appearance	White or gray powder
Bulk density	1,5 ± 0,1 gr/cm ³
Mixing water	23 ± 2 % (5,25 - 6,25 L per bag)
Coverage*	16 kg/m ²
Open time**	30 minutes.
Maximum thickness per coat	15 mm
Curing time**	1 - 4 hours
Flexural strength test	≥ 1 N/mm ²
Compressive strength test	3,5 ≤ R _c ≤ 6
Adhesion to ceramic brick	≥ 0.3 N/mm ²
Water absorption coefficient by capillarity (kg/m ² min ^{0.5})	W _{c2} ≤ 0.4
Reaction to fire	CLASS A1

* Test carried out at 10 mm thickness.

** Tests performed under normal ambient conditions 20 °C and 60% relative humidity. Variations in these conditions will result in variations in the stated times.



Instructions for use

Mix with the indicated amount of water.

Apply manually or by machine.

Spread evenly, leaving the most uniform layer possible.

The substrate must be clean and free of laitance and release agents.

Do not apply on damp surfaces or on substrates with loose particles.

Do not apply on gypsum-based substrates or on painted surfaces.

Compliance Standards

Do not apply on substrates affected by moisture.

Application temperature: from + 5 °C to + 30 °C.

Do not apply in direct sunlight, strong wind, rain, or when there is a risk of frost.

Do not apply in direct sunlight, strong wind, rain, or when there is a risk of frost.

Apply on substrates such as brick or block, previously rendered or leveled.

The product layer thickness shall be between 10 and 15 mm.

For each mix respect the indicated water ratio to avoid color variations.

Presentation

It is packaged in double-layer paper bags with a plastic sheet. The product is presented on shrink-wrapped pallets with 56 bags (1400 kg) of 25 kg each.

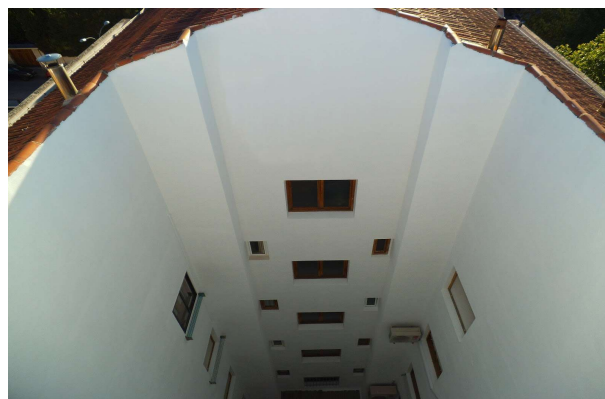

MONOCAPA RASPADO

VISANREVES



Characteristics

VISANREVES RASPADO is a white mineral mortar for the coating and decoration of facades, characterized by being waterproof, breathable, and optionally colored. Indicated for achieving a traditional scraped or urstic finish.

Cement-based product, with mineral pigments, selected and lightweight aggregates, conveniently added to achieve good workability and an excellent decorative finish. Suitable for manual or machine application, providing good resistance for both interiors and exteriors.

A product that decorates and protects; the wall breathes, making your home a healthier environment.

Available in all colors from our color chart.

Applications

It is a scraped finish product, suitable for cladding and decorating brick and concrete block facades. The minimum thickness is 12-15 mm, applicable both indoors and outdoors, on walls and ceilings, in new construction and renovation projects.

Since it can be applied directly to brick, a preliminary layer of plaster is not required.

If it is to be used on concrete or precast slabs, a bonding agent must be applied.

Waterproofing will be most effective when the applied layer after scraping is at least 10 mm thick.

The product provides a fine textured finish, allowing it to be washed or troweled.

Storage

The product should be kept in its original packaging and stored in a dry place, this way, it can be stored for up to twelve months.

PHYSICAL AND CHEMICAL PROPERTIES

Product type	OC CS III W2
Appearance	White or colored powder
Bulk density	1,5 ± 0,1 g/cm ³
Mixing water	24 ± 2 % (5,5 - 6,5 L per bag)
Hardened product density	1,6 ± 0,1 g/cm ³
Coverage*	16 kg/m ²
Open time**	20 min
Maximum thickness per coat	15 mm
Re-scraping time**	4 - 6 hours
Flexural strength test	≥ 1 N/mm ²
Compressive strength test	3.5 ≤ R _c ≤ 6.5 N/mm ²
Adhesion to ceramic brick	≥ 0.3 N/mm ²
Water absorption coefficient by capillarity (kg/m ² min ^{0.5})	W _{c2} ≤ 0,2
Reaction to fire	CLASS A1

* Test carried out at 10 mm thickness.

** Tests performed under normal ambient conditions 20 °C and 60% relative humidity. Variations in these conditions will result in variations in the stated times.



Instructions for use

Mix with the indicated amount of water until a smooth paste is obtained.

Let it rest for 5 minutes.

Spread, creating a layer as even as possible to a maximum thickness of 15 mm.

Let it harden for 4 to 10 hours, depending on the ambient conditions.

Scrape evenly with a scraping trowel or a saw blade.

Brush the surface with a soft-bristled brush to remove any dust.

Compliance Standards

Do not apply to surfaces affected by moisture.

Application temperature + 5 °C to + 30 °C.

Do not apply in direct sunlight, strong winds, rain, or when there is a risk of frost.

Do not apply intense colors at low temperatures to prevent efflorescence.

Do not apply to damp surfaces or surfaces with loose particles.

Do not apply to plaster or painted surfaces.

Apply to surfaces such as brick, block, or previously plastered or leveled surfaces. The thickness of the scraped product layer will be between 10 and 12 mm.

Respect the indicated water ratio in each bath to avoid changes in color.

Presentation

It is packaged in double-layer paper bags with a plastic sheet.

The product is presented on shrink-wrapped pallets with 56 bags (1400 kg) of 25 kg each.

